

Technical manual **EN**

Technisches Handbuch **DE**

Livret technique **FR**

Technisch boek **NL**

MARK ECOFAN PI 40

06 60 550_R03



Read this document before installing the appliance

Warning

Incorrect installation, adjustment, alteration, repair or maintenance work may lead to material damage or injury. All work must be carried out by certified, qualified professionals. If the appliance is not positioned in accordance with the instructions, the warranty shall be rendered void. This appliance is not intended for use by children or persons with a physical, sensory or mental handicap, or who lack the required experience or expertise, unless they are supervised or have been instructed in the use of the appliance by somebody who is responsible for their safety. Children must be supervised to ensure that they do not play with the appliance.

All rights reserved

The manufacturer has a policy of continuous product improvement and reserves the right to make changes to the specifications without prior notice. The technical details are considered correct but do not form the basis for a contract or warranty. All orders are accepted subject to the standard terms and conditions of sale and delivery (which will be sent to you at your request). The information in this document is subject to change without notice. The most recent version of this manual is always available at www.markclimate.com/downloads.

General warnings

Installation must comply with the relevant local and/or national regulations. You must therefore have the Ecofan PI40 installed by a professionally qualified installer in accordance with all applicable national and international regulations. Faulty installation, adjustment, alteration, maintenance activity or repair shall render the warranty void.

The Ecofan PI40 is supplied with 2 downrod lengths:

- 400 mm fitted, giving 610mm overall height (from ceiling to base of motor body)
- 150mm downrod supplied separately, giving 360mm overall height (from ceiling to base of motor body).

1.0 General

- 1.1 This appliance must be earthed.
- 1.2 Check that the voltage and frequency on both the fan motor and controller (if fitted) rating labels correspond with your electrical supply.
- 1.3 The installation must be provided with a double pole isolator switch having a contact separation of not less than 3mm and protected with a 5 Amp fuse.
- 1.4 Ensure that the safety wire is connected to the J-hook bracket before operating the fan.

2.0 Installation

Ensure that the mains supply is isolated before proceeding

2.1 Decide on the position the fan is to be sited; it must be a minimum of 2.3m from the floor to the lowest point on the fan. (A shorter 150mm long downrod is supplied with the fan if required. Refer to the section on installing the shorter downrod).

2.2 Stick a vibration damper on the bracket of the J-hook. Fix the ceiling J-hook (supplied) firmly to a timber joist or concrete ceiling with the screws supplied (or similar). Ensure that the fixing bracket in the ceiling is able to support a hanging weight of 15kg minimum. (Fig A)

2.3 Fit the three blades to the fan body. (Fig B)

2.4 Hang the fan on the hook with the safety wire, then hook up the fan on the black rubber roller making sure that all wires are clear.

2.5 Connect supply wires to the fan using the terminal block at the top of the downrod. (Fig C, next page)

2.6 Secure upper canopy with screws fitted to cover the wiring connections.

2.7 Tighten all screws including the earth connections.

2.8 Switch on supply and check fan function.

Fig.A

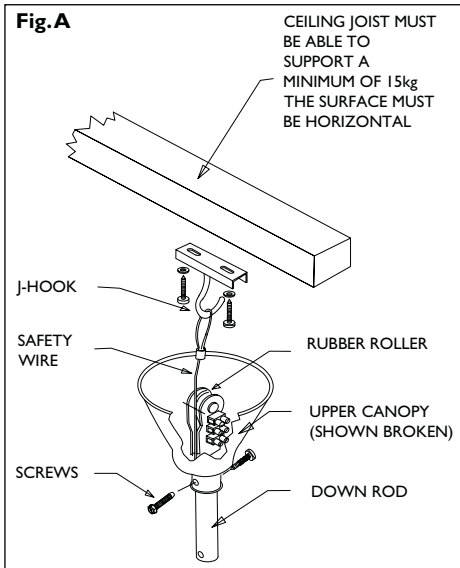
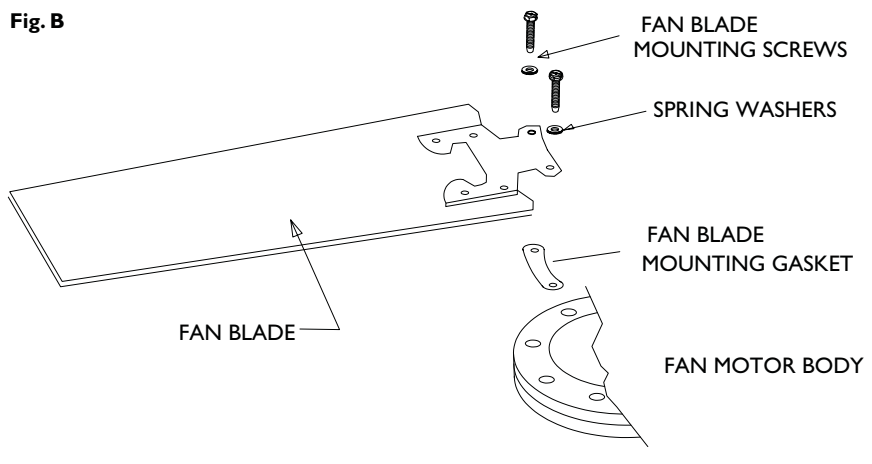

Fig. B



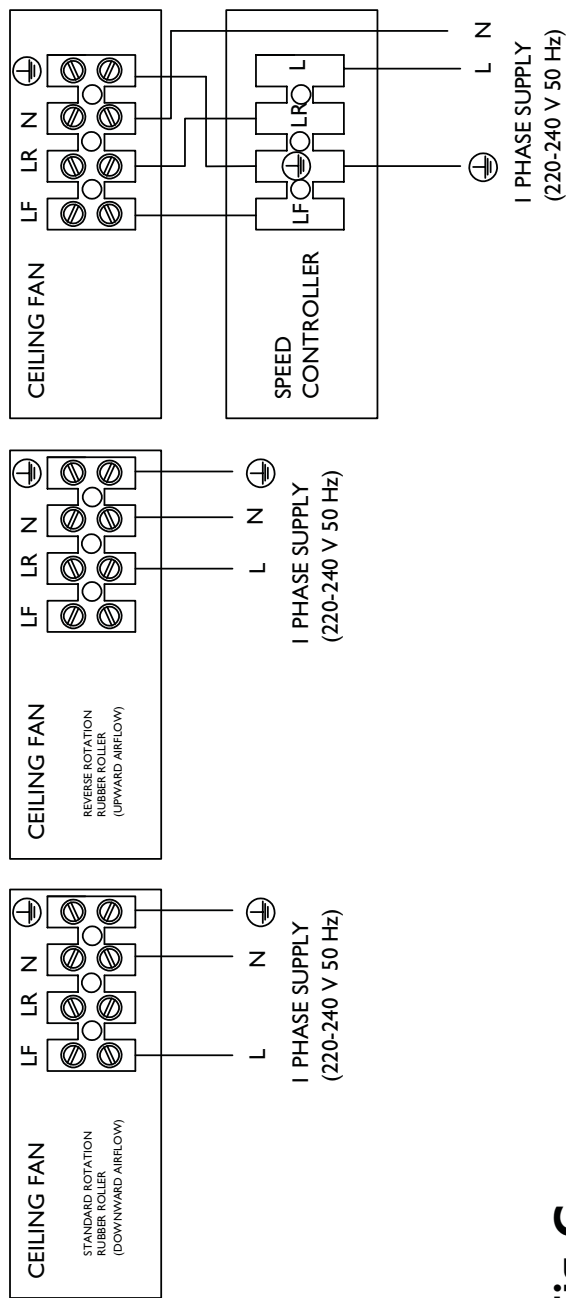

Fig. C

3.0 Instructions for changing to shorter 150mm downrod

Ensure that the mains supply is isolated before proceeding

EN

3.1 Loosen the lower canopy screws and slide the canopy up the downrod.
3.2 Disconnect the Brown (LF), Red (LR) and Blue (N) wires, which run up the downrod from the lower terminal block located just above fan motor body.

3.3 Disconnect the Earth (Green/Yellow) wire from the lower mounting bracket which also runs up inside the downrod.

3.4 Carefully remove the split pin and the downrod securing bolt.

3.5 Loosen the upper canopy screws and slide canopy down the downrod.

3.6 Carefully remove the split pin and downrod securing bolt and then disconnect the Earth wire.

3.7 Carefully remove the existing downrod passing the disconnected feed wires through the rod along with the safety wire.

3.8 Replace with the 150mm long downrod supplied.

3.9 Pass the feed wires through the new Rod along with the safety wire.

3.10 Replace the upper and lower downrod securing bolts and split pins.

3.11 The feed wires will need to be cut and stripped to suit the shorter rod and then re-connected to the lower terminal block Brown (LF), Red (LR) and Blue (N).

3.12 Re-connect all Earth (Green/Yellow) wires.

3.13 Because the shorter downrod has been required for our particular installation, it is recommended that the safety wire is reduced in length to protrude 75mm above the height of the 150mm downrod. The loop for the safety wire will need re-making by using a wire rope grip or crimp (Supplied by others). It is essential that the new safety wire loop will withstand the weight of the fan in the event of it falling.

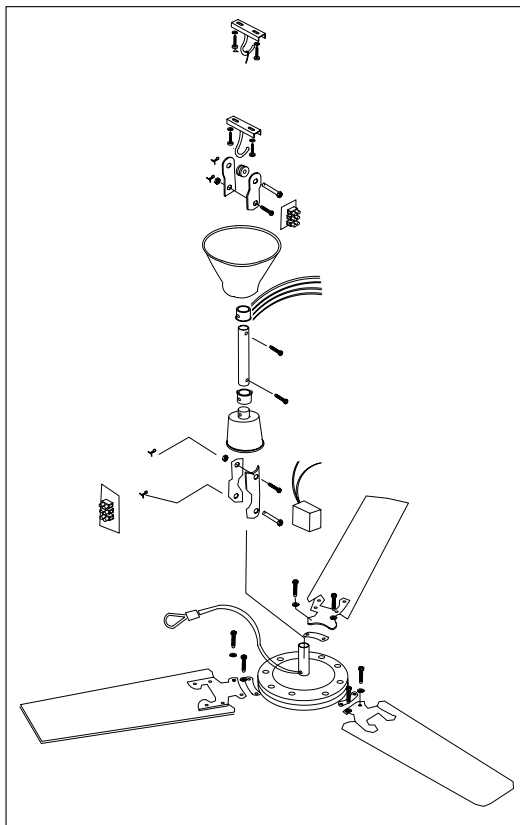

Important

All fixings must be tight before operating the fan. It is advisable to check/inspect all the fixings annually, and re-tighten as necessary. This fan is guaranteed for one year from the date of purchase against faulty material or workmanship. In the event that any part is found to be defective please contact your local supplier stating the nature of the fault and providing evidence of the date and source of purchase.