

## Manifold kit art. CI 562MN - CI 594MN

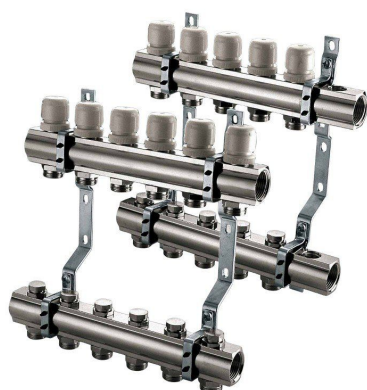

CI 562MN and CI 594MN kits are distribution systems consisting of delivery and return manifolds with built-in mounting brackets for an easy housing into the box. Delivery manifolds feature lockshield-type inserts by which the distribution circuits can be balanced. Return manifolds are equipped with thermostatically controllable inserts for flow interception, and protection caps. With respect to CI 562MN, CI 594MN kit features a free way both on the delivery and on the return manifolds for fill-drain cocks and automatic air-vent valves. All distribution manifolds are obtained from drawn brass bars with a special profile. They are machined and assembled automatically by innovative machinery; they then undergo stress relief heat treatment, in order to minimise crack risk. Each manifold is tested under pressure with all the fittings and accessories mounted to be sure that there are no leaks. Threads on the main column connections comply with ISO228 standard. Derivation pipes are connected by means of two types of fittings, M24×1.5 thread or 3/4" EUROKONUS, sealed by glued o-rings to ensure they do not loosen when

disassembling the fitting. Where foreseen, manifolds are available both with "yellow" and nickel-plated surface (product code final "N"). CI-series manifold kits are suitable for radiant floor heating systems. In particular, manifolds with lockshield-type inserts, used as delivery manifolds, allow to balance the circuit by a double micrometric adjustment with position memory, very useful in case of temporary closures for maintenance operations.

### ■ TECHNICAL FEATURES

Max operating temperature: 120 °C  
Max operating pressure: 10 bar

### ■ MATERIALS

Brass parts: CW617N  
Seal parts: peroxide EPDM  
Cut-off knobs: ABS

## ■ DIMENSIONS

**CI 562MN. Kit of adjustment and manually-operated shut-off manifolds with built-in brackets and fittings (flow: CI 552N; return: CI 554MN)**

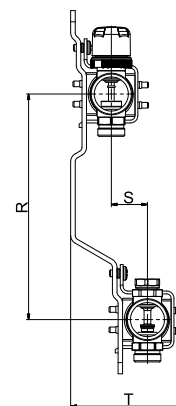
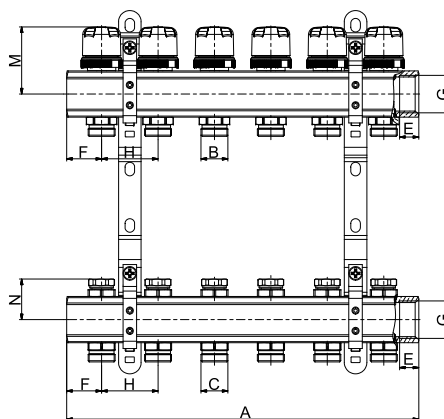

**CI 594MN. Kit of adjustment and manually-operated shut-off manifolds with built-in brackets and fittings with supplementary connections for air-vent valves and fill-drain taps (flow: CI 553N; return: CI 555MN)**

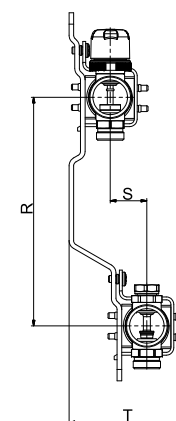
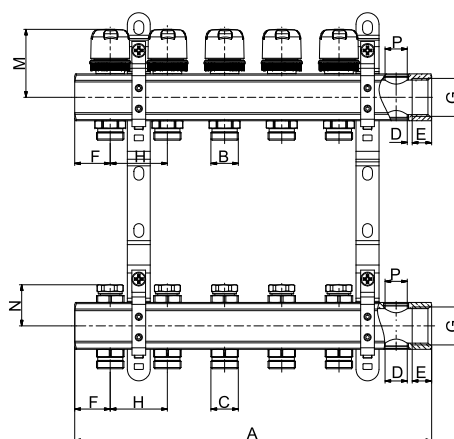

## CI 562MN - Dimensions and product codes

WAYS	COD.	SIZE	A	B	C	D	E	F	G	H	M	N	P	R	S	T
2	400222MN	1"×M24	112	M24×1.5	M24×1.5	-	17	31	1"	50	60	36	-	200	32	100
	400242MN	1"×EK		3/4"	3/4"											
	400262MN	1 1/4"×M24	114	M24×1.5	M24×1.5		19	32	1 1/4"		65	41				
	400282MN	1 1/4"×EK		3/4"	3/4"											
3	400223MN	1"×M24	162	M24×1.5	M24×1.5		17	31	1"		60	36				
	400243MN	1"×EK		3/4"	3/4"											
	400263MN	1 1/4"×M24	164	M24×1.5	M24×1.5		19	32	1 1/4"		65	41				
	400283MN	1 1/4"×EK		3/4"	3/4"											
4	400224MN	1"×M24	212	M24×1.5	M24×1.5		17	31	1"		60	36				
	400244MN	1"×EK		3/4"	3/4"											
	400264MN	1 1/4"×M24	214	M24×1.5	M24×1.5		19	32	1 1/4"		65	41				
	400284MN	1 1/4"×EK		3/4"	3/4"											
5	400225MN	1"×M24	262	M24×1.5	M24×1.5		17	31	1"		60	36				
	400245MN	1"×EK		3/4"	3/4"											
	400265MN	1 1/4"×M24	264	M24×1.5	M24×1.5		19	32	1 1/4"		65	41				
	400285MN	1 1/4"×EK		3/4"	3/4"											
6	400226MN	1"×M24	312	M24×1.5	M24×1.5		17	31	1"		60	36				
	400246MN	1"×EK		3/4"	3/4"											
	400266MN	1 1/4"×M24	314	M24×1.5	M24×1.5		19	32	1 1/4"		65	41				
	400286MN	1 1/4"×EK		3/4"	3/4"											
7	400227MN	1"×M24	362	M24×1.5	M24×1.5		17	31	1"		60	36				
	400247MN	1"×EK		3/4"	3/4"											
	400267MN	1 1/4"×M24	364	M24×1.5	M24×1.5		19	32	1 1/4"		65	41				
	400287MN	1 1/4"×EK		3/4"	3/4"											
8	400228MN	1"×M24	412	M24×1.5	M24×1.5		17	31	1"		60	36				
	400248MN	1"×EK		3/4"	3/4"											
	400268MN	1 1/4"×M24	414	M24×1.5	M24×1.5		19	32	1 1/4"		65	41				
	400288MN	1 1/4"×EK		3/4"	3/4"											
9	400229MN	1"×M24	462	M24×1.5	M24×1.5		17	31	1"		60	36				
	400249MN	1"×EK		3/4"	3/4"											
	400269MN	1 1/4"×M24	464	M24×1.5	M24×1.5		19	32	1 1/4"		65	41				
	400289MN	1 1/4"×EK		3/4"	3/4"											
10	400230MN	1"×M24	512	M24×1.5	M24×1.5		17	31	1"		60	36				
	400250MN	1"×EK		3/4"	3/4"											
	400270MN	1 1/4"×M24	514	M24×1.5	M24×1.5		19	32	1 1/4"		65	41				
	400290MN	1 1/4"×EK		3/4"	3/4"											
11	400231MN	1"×M24	562	M24×1.5	M24×1.5		17	31	1"		60	36				
	400251MN	1"×EK		3/4"	3/4"											
	400271MN	1 1/4"×M24	564	M24×1.5	M24×1.5		19	32	1 1/4"		65	41				
	400291MN	1 1/4"×EK		3/4"	3/4"											
12	400232MN	1"×M24	612	M24×1.5	M24×1.5		17	31	1"		60	36				
	400252MN	1"×EK		3/4"	3/4"											
	400272MN	1 1/4"×M24	614	M24×1.5	M24×1.5		19	32	1 1/4"		65	41				
	400292MN	1 1/4"×EK		3/4"	3/4"											
13	400233MN	1"×M24	662	M24×1.5	M24×1.5		17	31	1"		60	36				
	400253MN	1"×EK		3/4"	3/4"											
	400273MN	1 1/4"×M24	664	M24×1.5	M24×1.5		19	32	1 1/4"		65	41				
	400293MN	1 1/4"×EK		3/4"	3/4"											

## CI 594MN - Dimensions and product codes

WAYS	COD.	SIZE	A	B	C	D	E	F	G	H	M	N	P	R	S	T		
2	400302MN	1"×M24	162	M24×1.5	M24×1.5	1/2"	17	31	1"	50	60	36	1/2"	200	32	100		
	500922MN	1"×EK		3/4"	3/4"													
	400322MN	1 1/4"×M24	164	M24×1.5	M24×1.5		19	32	1 1/4"		65	41						
	400342MN	1 1/4"×EK		3/4"	3/4"													
3	400303MN	1"×M24	212	M24×1.5	M24×1.5		17	31	1"		60	36						
	500923MN	1"×EK		3/4"	3/4"													
	400323MN	1 1/4"×M24	214	M24×1.5	M24×1.5		19	32	1 1/4"		65	41						
	400343MN	1 1/4"×EK		3/4"	3/4"													
4	400304MN	1"×M24	262	M24×1.5	M24×1.5		17	31	1"		60	36						
	500924MN	1"×EK		3/4"	3/4"													
	400324MN	1 1/4"×M24	264	M24×1.5	M24×1.5		19	32	1 1/4"		65	41						
	400344MN	1 1/4"×EK		3/4"	3/4"													
5	400305MN	1"×M24	312	M24×1.5	M24×1.5		17	31	1"		60	36						
	500925MN	1"×EK		3/4"	3/4"													
	400325MN	1 1/4"×M24	314	M24×1.5	M24×1.5		19	32	1 1/4"		65	41						
	400345MN	1 1/4"×EK		3/4"	3/4"													
6	400306MN	1"×M24	362	M24×1.5	M24×1.5		17	31	1"		60	36						
	500926MN	1"×EK		3/4"	3/4"													
	400326MN	1 1/4"×M24	364	M24×1.5	M24×1.5		19	32	1 1/4"		65	41						
	400346MN	1 1/4"×EK		3/4"	3/4"													
7	400307MN	1"×M24	412	M24×1.5	M24×1.5		17	31	1"		60	36						
	500927MN	1"×EK		3/4"	3/4"													
	400327MN	1 1/4"×M24	414	M24×1.5	M24×1.5		19	32	1 1/4"		65	41						
	400347MN	1 1/4"×EK		3/4"	3/4"													
8	400308MN	1"×M24	462	M24×1.5	M24×1.5		17	31	1"		60	36						
	500928MN	1"×EK		3/4"	3/4"													
	400328MN	1 1/4"×M24	464	M24×1.5	M24×1.5		19	32	1 1/4"		65	41						
	400348MN	1 1/4"×EK		3/4"	3/4"													
9	400309MN	1"×M24	512	M24×1.5	M24×1.5		17	31	1"		60	36						
	500929MN	1"×EK		3/4"	3/4"													
	400329MN	1 1/4"×M24	514	M24×1.5	M24×1.5		19	32	1 1/4"		65	41						
	400349MN	1 1/4"×EK		3/4"	3/4"													
10	400310MN	1"×M24	562	M24×1.5	M24×1.5		17	31	1"		60	36						
	500930MN	1"×EK		3/4"	3/4"													
	400330MN	1 1/4"×M24	564	M24×1.5	M24×1.5		19	32	1 1/4"		65	41						
	400350MN	1 1/4"×EK		3/4"	3/4"													
11	400311MN	1"×M24	612	M24×1.5	M24×1.5		17	31	1"		60	36						
	500931MN	1"×EK		3/4"	3/4"													
	400331MN	1 1/4"×M24	614	M24×1.5	M24×1.5		19	32	1 1/4"		65	41						
	400351MN	1 1/4"×EK		3/4"	3/4"													
12	400312MN	1"×M24	662	M24×1.5	M24×1.5		17	31	1"		60	36						
	500932MN	1"×EK		3/4"	3/4"													
	400332MN	1 1/4"×M24	664	M24×1.5	M24×1.5		19	32	1 1/4"		65	41						
	400352MN	1 1/4"×EK		3/4"	3/4"													

## HYDRAULIC FEATURES

### Flow manifold

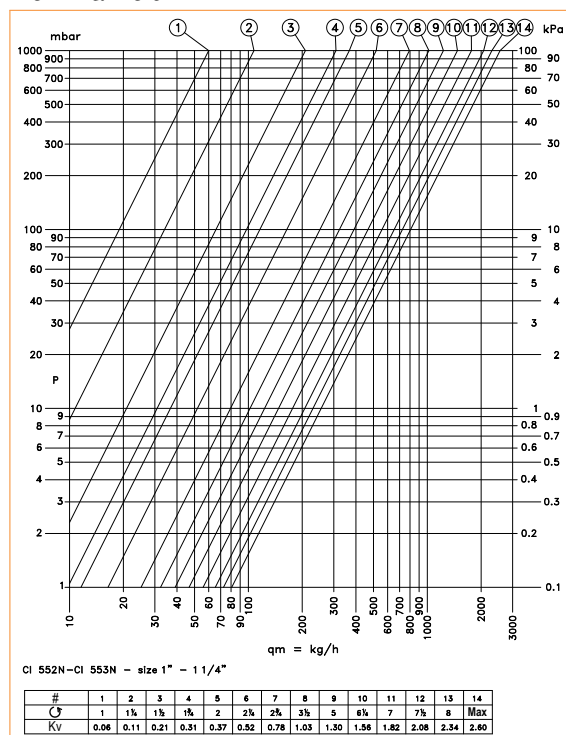

### Return manifold

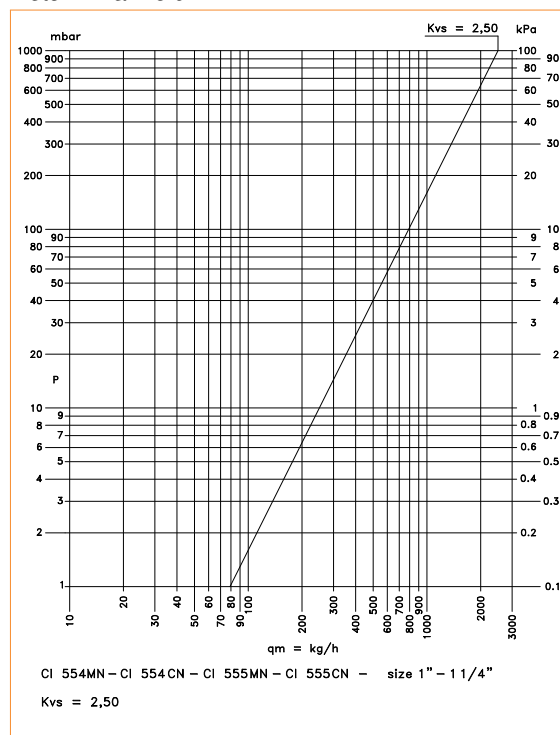

○ = number of turns from closure position

Max = completely open position

## OPERATING INSTRUCTIONS

### Adjustment

Delivery manifolds in CI 562MN and CI 594MN kits feature double-micrometric-adjustment lockshields to balance the flow rates of the different distribution circuits. For a correct adjustment, proceed as follows:

1. Use a screwdriver to unscrew and extract the notched screw located within the hexagonal key-way;
2. Use a 5 mm allen key to close the large adjustment screw (Fig.1a);
3. Screw the notched screw all the way back in. Then, mark the adjustment reference point with an "x" (Fig.1b);
4. Align the screwdriver with the "x";
5. Loosen the screw by the proper number of turns (Fig.1c), based on the attached Kv diagram;
6. Open the large screw completely (Fig.1d).

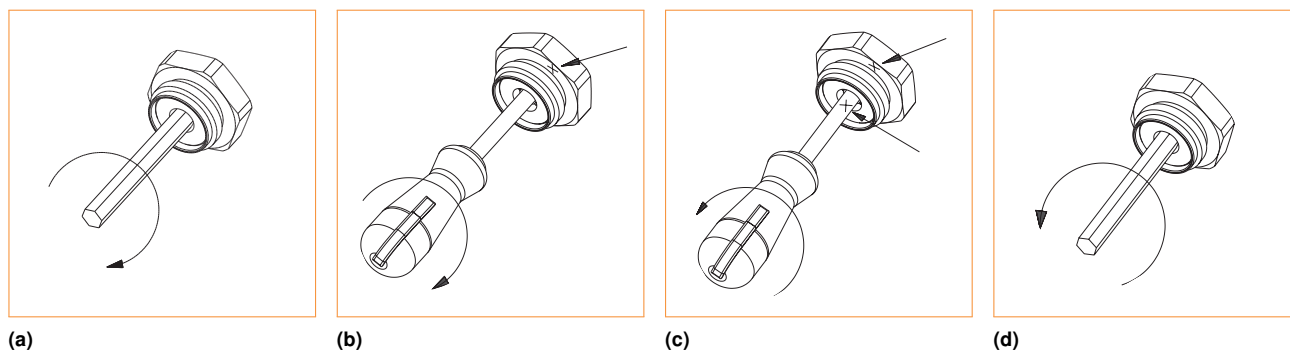

**Fig. 1:** Lockshield adjustment.

I.V.A.R. S.p.A.  
Via IV Novembre 181  
25080 Prevalle (BS)  
Tel. +39 030 68028  
Fax +39 030 6801329  
[www.ivar.eu](http://www.ivar.eu) - [info@ivar.eu](mailto:info@ivar.eu)

*I.V.A.R. S.p.A. reserves the right to make enhancements and changes to products and relative documentation at any time without prior notice. All rights reserved. Reproduction, even partial, is forbidden without prior permission by the copyright owner.*