

F1-F4 AND B1-B4  
DN65 PN10/16  
2.5" ANSI CLASS150  
CLADDED OR RUBBERLINED

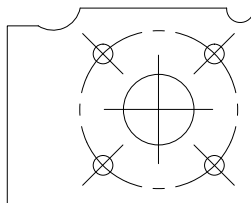

F1-F4  
DN65 PN10/16  
2.5" ANSI CLASS150  
UNCLADDED

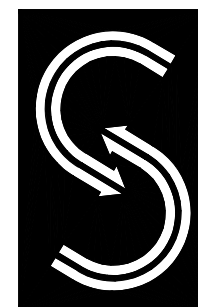
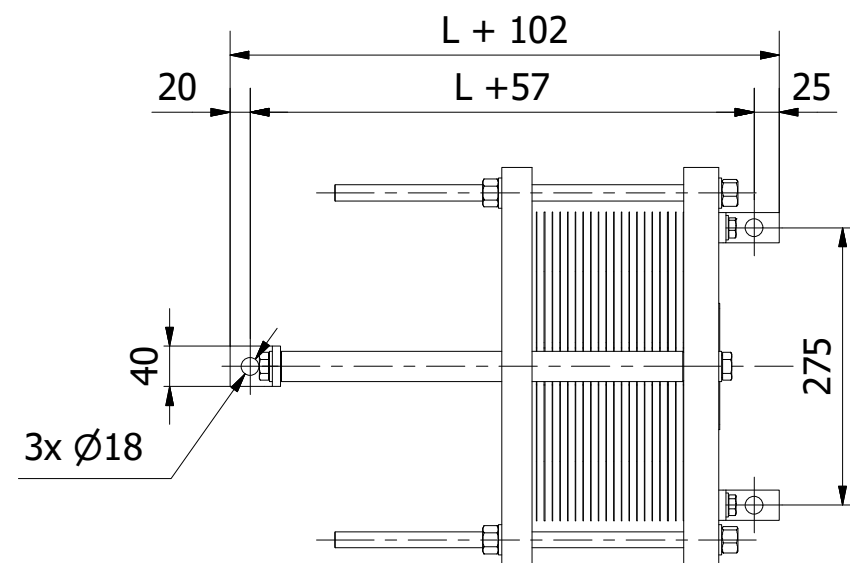
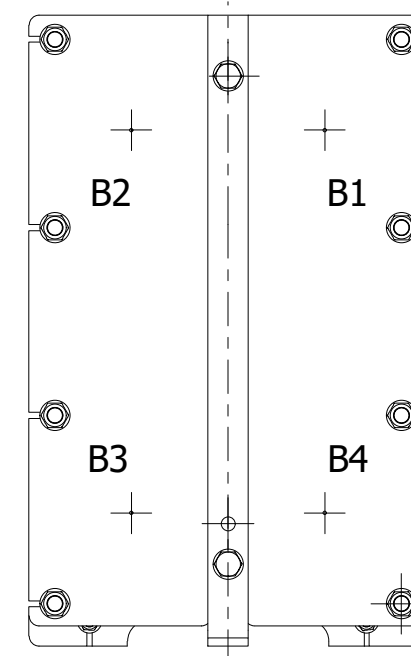
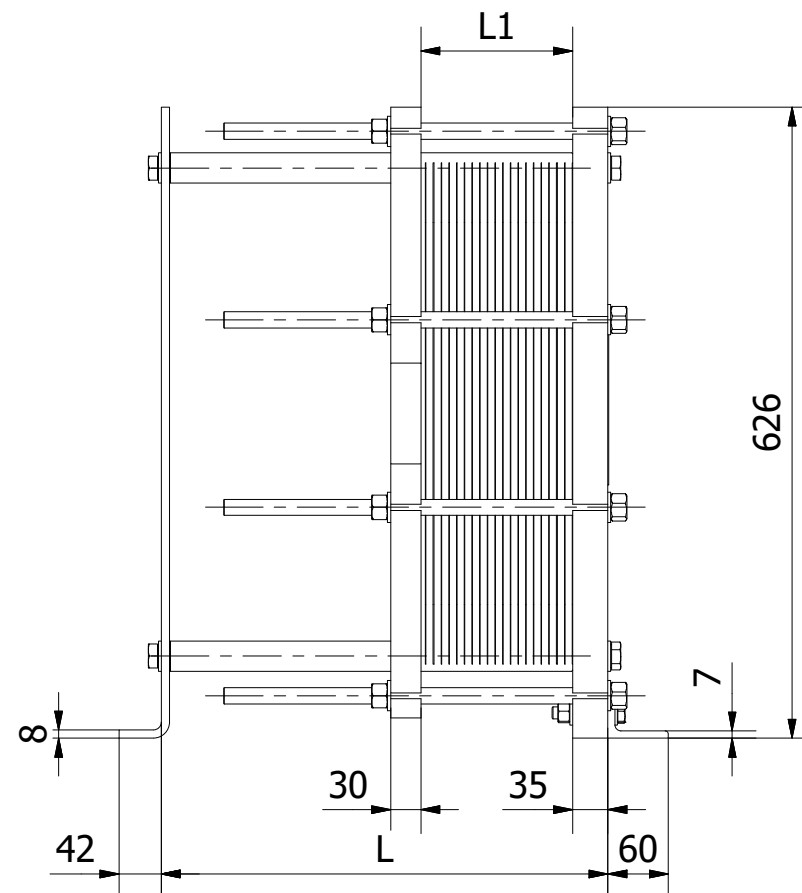
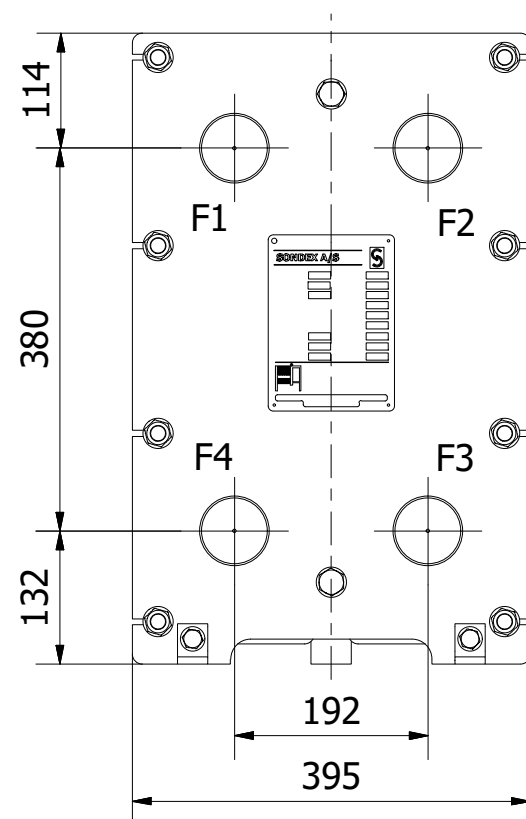
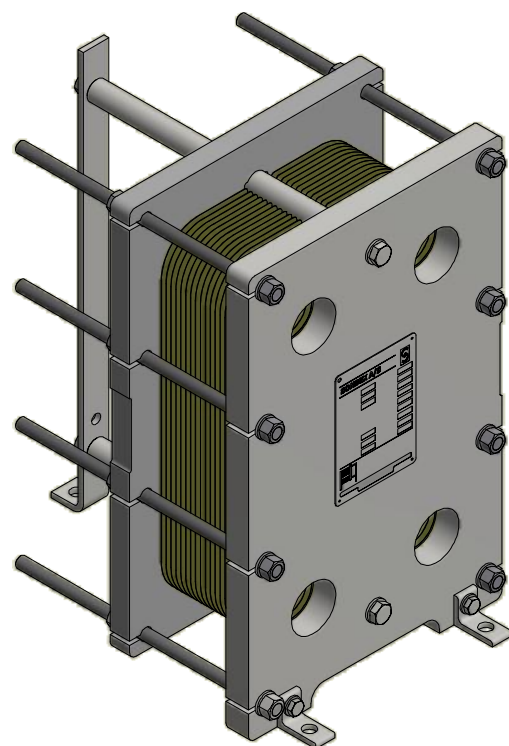

Dimensions  
without tolerance:  
ISO 2768-m  
ISO projection

Designed by JKO 15-06-2009  
Date 15-06-2009  
Approved by HAT 18-11-2019  
Date 18-11-2019  
**SONDEX**  
Marsvej 5  
DK-6000 Kolding

Rev. no. 06	Revision Text One M16 nut on clampingbolts was removed		
Description: S9a IG PN10 DN65 DIM DRAWING - FEA LENGTH 400-1000 MM			
Rev. date 15-11-2019	Rev. by VICS	Drawing no. S9a/GPN10DN65L400-1000-FEA	Sheet 1 / 1