

EXTRA 1 HORIZONTAL

POLYWARM® COATED CALORIFIERS WITH 1 STAINLESS STEEL EXTRACTABLE HEAT EXCHANGER



APPLICATION

Production and storage of domestic hot water (DHW).

MATERIAL

Mild steel Polywarm® coated (Attestation ACS - SSICA - DVGW - W270 - WRAS)

HEAT EXCHANGER

Stainless steel 316L heat exchanger

INSULATION (DISMOUNTABLE)

NOFIRE® polyester fleece 100% made of recyclable material, with high thermal insulation. Fire resistance class B-s2d0 according to EN 13501.

Grey PVC external lining.

CATHODE PROTECTION

Magnesium anode. Models > 1500 n° 2 magnesium anodes.

GASKET- FLANGE PLATE

Silicone gaskets suitable for water intended for human consumption (tested according to 98/83/CE), max temperature up to 200°C. Mild steel exchanger head with anticorrosion treatment.

WARRANTY

5 years - See general sales conditions and warranty

ACCESSORIES AND SPARE PARTS

See Accessories section for the entire list.

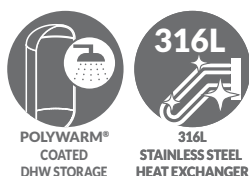

EXTRA 1 WXC OR

STAINLESS STEEL 316L ENERGY EFFICIENCY CLASS

DISMOUNTABLE SOFT FLEECE insulation HEAT EXCHANGER SURFACE

Model	Art. Nr.	[m²]	ErP
200	3072161430031	0,5	C
300	3072161430032	0,75	C
500	3072161430033	1	C
800	3072161430034	1,5	C
1000	3072161430035	2	C
1500	3072161430036	3	C
2000	3072161430037	4	C
3000	3072161430008	5	
4000	3072161430009	8	
5000	3072161430011	10	

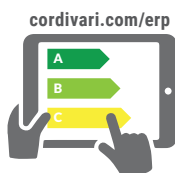

On line ErP label tool



Data have been calculated on following basis: Primary circuit at 80 °C, and proper energy source; Production of DHW in continue way from 10 °C to 45 °C; DHW that can be taken in the first 10' and in the first hour from storage at 60°C, input 10°C and output 45°C; Sanitary water according to UNI CT1 8065. Even if tanks are tested to resist till max temperature, the local legislation has always to be observed during the use.

Model	Ignition Time [min]	Output [Kw]	Continuous production of DHW [lt/h]	DHW produced in the first 10 Min. [lt/10']	DHW produced in the first hour [lt/60']	Primary flow rate [m³/h]	Exchanger pressure loss [mm H ₂ O]	[mbar]
200	49	18	455	347	635	2	309	30,3
300	48	28	701	524	968	3	372	36,5
500	60	38	947	844	1443	4	419	41,1
800	59	59	1466	1301	2230	6	718	70,4
1000	54	86	2127	1776	3123	10	1380	135,3
1500	53	133	3290	2677	4761	15	2295	225,1
2000	52	180	4453	3564	6384	20	2996	293,8
3000	65	216	5361	5144	8539	20	2436	238,9
4000	57	330	8168	6918	12092	20	3896	382,1
5000	60	401	9921	8639	14923	20	4707	461,6

ACCESSORIES

"Easy Control" Electronic Display-mounted on tank

ART. NR.	FOR MODELS
5005000310002	WXC



Thermometer

Art. Nr.
5032240000107
5 units box



Titanium electronic anode

Art. Nr.	Model
5200000000008	200, 300
5200000000009	500, 800
5200000000011	1000, 1500
5200000000013	2000÷5000



EXTRA 1 HORIZONTAL

POLYWARM® COATED CALORIFIERS WITH 1 STAINLESS STEEL EXTRACTABLE HEAT EXCHANGER

STORAGE		HEAT EXCHANGER	
Pmax	Tmax	Pmax	Tmax
8 bar	90 °C	12 bar	110 °C



CORDIVARI Lab

TÜV Rheinland Energie und Umwelt GmbH states that test procedures and Cordivari LAB are certified conforming to European standard EN 15332, as indicated by Ecodesign ErP Directive.

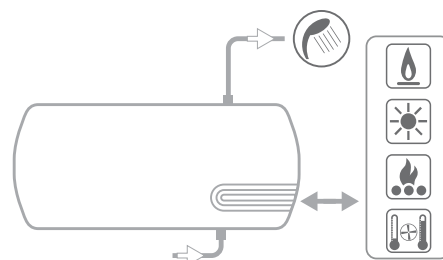

See TECHNICAL SUPPORT chapter for example of installation

A	Domestic hot water outlet
B	Recirculation
C-D	Connection for instrumentation 1/2" F
E	Connection for 2nd magnesium anode 1"1/4 F (only for models > 1500)
G	Connection for magnesium anode
H	Heat exchanger drain 3/8" F
I	Primary circuit inlet
L	Primary circuit outlet
M-N	Domestic water inlet / Drain
P	Heat exchanger flange

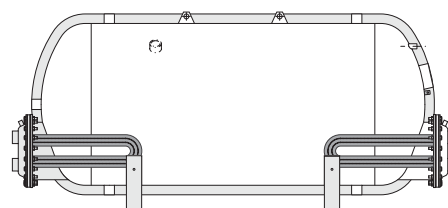
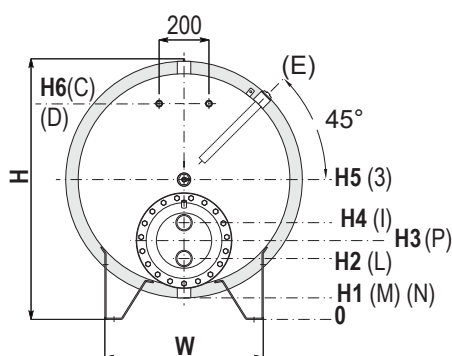
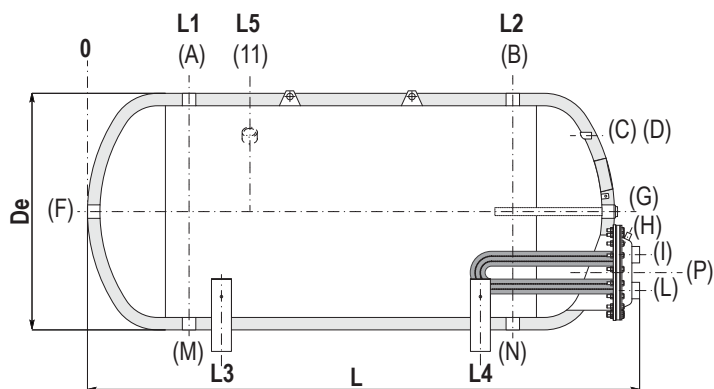

VERSION WITH 2 EXTRACTABLE HEAT EXCHANGERS IS AVAILABLE UPON REQUEST

Model	Volume [lt]	De	L	H	L1	L2	L3	L4	L5	H1
200	191	670	1594	693	344	1144	409	1079	//	43
300	292	770	1645	849	370	1170	440	1100	//	99
500	500	870	1934	946	395	1445	490	1350	//	96
800	795	970	2251	1042	425	1725	555	1595	//	92
1000	1045	1070	2281	1137	458	1758	588	1628	//	87
1500	1498	1210	2651	1240	474	2024	629	1869	//	90
2000	2064	1360	2706	1380	520	2070	660	1930	908	80
3000	2997	1350	2956	1524	495	2295	695	2095	945	154
4000	4184	1550	3066	1707	560	2360	665	2255	1010	137
5000	5131	1700	3107	1845	583	2383	783	2183	1033	125

Model	H2	H3	H4	H5	H6	W	P	L-I	C-D	B	A-M-N	E
200	243	293	343	368	498	364	Øi220/Øe300	1"	1/2"	1"1/4	1"1/4	-
300	336	386	436	474	668	404	Øi220/Øe300	1"	1/2"	1"1/4	1"1/4	-
500	383	433	483	521	715	455	Øi220/Øe300	1"	1/2"	1"1/4	1"1/4	-
800	348	438	528	567	817	583	Øi300/Øe380	2"	1/2"	1"1/4	1"1/2	-
1000	277	367	457	612	917	644	Øi300/Øe380	2"	1/2"	1"1/2	1"1/2	-
1500	315	405	495	665	1020	759	Øi300/Øe380	2"	1/2"	2"	2"	-
2000	330	435	540	730	1085	848	Øi350/Øe430	2"	1/2"	2"	2"	1"1/4
3000	324	429	534	829	1184	981	Øi350/Øe430	2"	1/2"	2"	2"	1"1/4
4000	307	412	517	912	1267	1101	Øi350/Øe430	2"	1/2"	2"	3"	1"1/4
5000	305	410	515	975	1330	1189	Øi350/Øe430	2"	1/2"	2"	3"	1"1/4